

NOVELTY

## PCP1293

CONTROL WITH BLUETOOTH DEVICE SUPPLIED  
AT 230 V AC

### MAIN CHARACTERISTICS:



- Stereo control to listen to music from any device that has blue-tooth: telephone, tablet, laptop, etc
- With On/Off pushbutton and volume control.
- 1.5+1.5W stereo amplifier.
- 8-ohm output.
- Direct power supply at 230 V AC.
- Installation in standard 60 mm diameter box.
- This control combines with many wiring devices.

### INSTALLATION EXAMPLE

#### STAND-ALONE SYSTEM

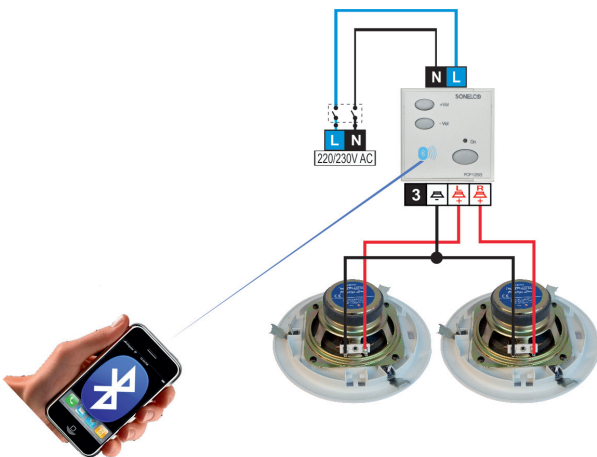

The easiest installation with the PCP1293

### THE ROOM FACILITIES THAT ANY HOTEL SHOULD HAVE

- TV
- Internet
- ...
- Bluetooth (to listen to your own music)



IDEAL FOR HOTELS, BATHROOMS, KITCHENS, SHOPS, ETC